

# Physical Security Sneeze Guards

Convenience. Access. Protection. Since 1859.

Sneeze guards are acrylic barriers placed at bank teller windows, pharmacy pickup, grocery checkout lines, and a number of other retail environments. Sneeze guards are used as a safety measure to help reduce the spread of viruses between customers and employees.

Physical barriers, like sneeze guards, are recommended in OSHA's [Guidance on Preparing Workplaces for COVID-19](#) which classifies them as an engineering control to protect all essential employees who have face-to-face contact with consumers.

## TELLER STATION GUARDS:

- Crystal-clear acrylic shield/guard
- Assembles easily with standard hand tools and hardware
- Alternate freestanding installation utilizing slotted laminate block
- Lightweight, impact-resistant and easy to clean



**Teller Window Shield**



**Teller Parapet Shield**

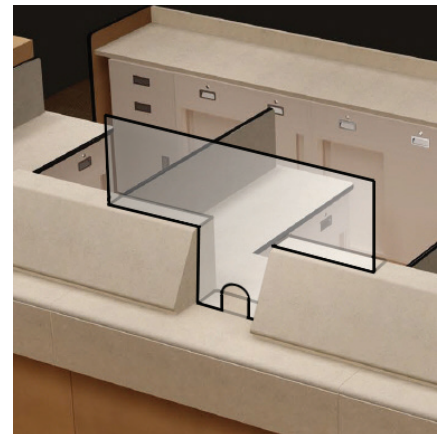

**Teller Station Shield**

Part Number	Description	Dimensions	Material
01770059148	Teller window shield/guard 15½" x 31½" w/ pass thru	15½" Wide x 31½" High	¼" acrylic
01770059149	Teller parapet shield/guard 43" X 16½"	43" Wide x 16½" High	¼" acrylic
01770059150	Teller parapet shield/guard 21" X 16½"	21" Wide x 16½" High	¼" acrylic
01770059151	Teller station shield/guard 59" x 31½" w/ pass thru	59" Wide x 31½" High	¼" acrylic
<b>Note:</b> Custom sizes and features available upon request.			

#### FREESTANDING/SURFACE/SUSPENDED GUARDS:

- Crystal-clear acrylic shield/guard
- Assembles easily with no tools
- Use multiple side-by-side for wider coverage
- Lightweight, impact-resistant and easy to clean
- Framed/adjustable solution allows flush shield to counter or select pass-through height
- Hanging/suspended shield (not shown)
  - Includes pre-drilled holes for simple chain/hook (by others) installation
- Large flat shield (not shown), retail checkout application

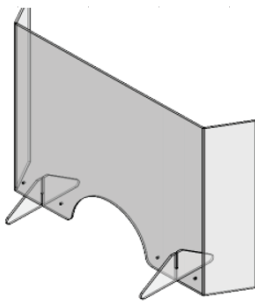

**FS Angled Shield**

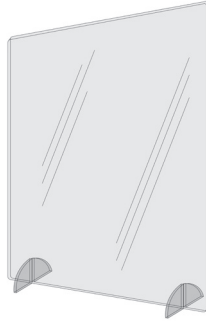

**FS Flat Shield**

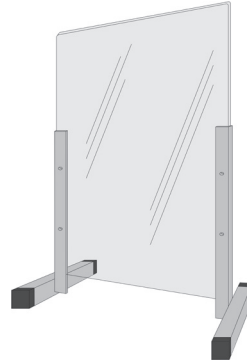

**FS Framed/Adjustable**

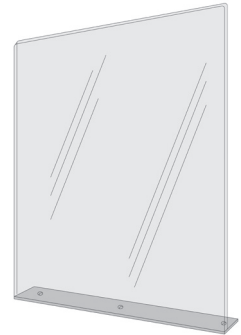

**SM Flat Shield**

Part Number	Description	Dimensions	Material
01770059152	FS angled shield 36½" x 24" w/ pass thru	36½" Wide x 24" High	⅛" acrylic
01770059153	FS framed/adjustable shield 24" X 32" w/ pass thru	24" Wide x 32" High	¼" acrylic
01770059154	SM flat shield 24" X 32" no pass thru	24" Wide x 32" High	¼" acrylic
01770059155	FS flat shield 24" x 32" no pass thru	24" Wide x 32" High	¼" acrylic
01770059156	Hanging flat shield 24" x 32" no pass thru	24" Wide x 32" High	¼" acrylic
01770059157	Large flat shield 36" x 36" no pass thru	36" Wide x 36" High	¼" acrylic

**Note:** Custom sizes and features available upon request.